

ASSEMBLY INSTRUCTIONS FOR: 1200 SERIES BITELOK TWO PIECE EXTERNAL SKIVE COUPLINGS. USE ONLY RYCO T240A HOSE.

Follow same steps as page 330, except for 1200 Series Couplings with T240A hose, Step 2 is as shown on right.

RYCO Crimp Chart detailing External Skive Length and Crimp Diameter is available from RYCO hydraulics.

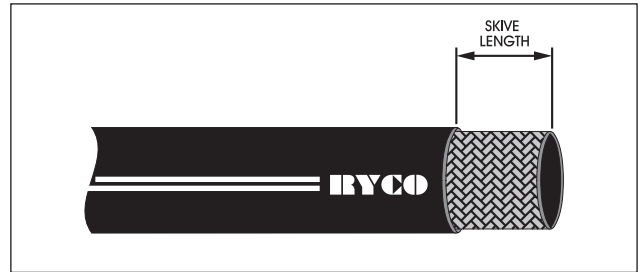

STEP TWO

Mark skive length. (Refer to "RYCO Crimp Chart"). Cut rubber cover around down to wire reinforcement. Slit lengthwise. Raise flap and pull off with pliers.

Intro

Hose

Assembly Instructions – RT7T and RT7TN Twin Hose

ASSEMBLY INSTRUCTIONS FOR: SEPARATION OF THE ENDS OF RT7T AND RT7TN TWIN HOSE.

Note: RYCO RT7T and RT7TN Hose must be separated at the ends to permit the attachment of the couplings. Procedure is as follows.

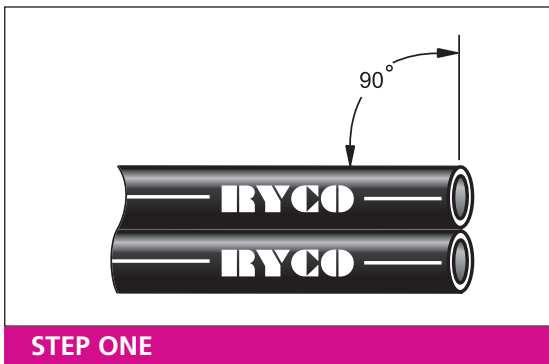

STEP ONE

Cut hose to length required using a sharp knife. Ensure hose is cut squarely. Clean hose bore.

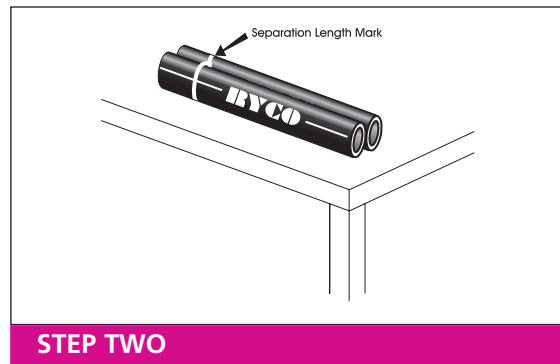

STEP TWO

Arrange the end of the twin line hose so that it is lying straight and flat, resting on the bottom of both hoses, on a horizontal work surface. Mark the length to be separated on the cover of the hoses. The separation length required may vary depending on the crimper being used. Separation length must allow each hose end to be inserted into the crimper without kinking the other hose.

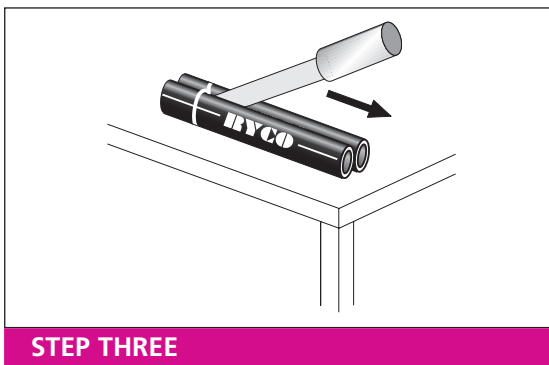

STEP THREE

Hold the hoses flat on the work bench, and lightly score along the joint between the two hoses with a blunt knife. Keep the knife vertical to avoid cover damage. It may be necessary to score along the joint several times. Take care not to damage the covers of the hoses. Turn the hose over and repeat the above to score the other side of the joint. The hoses will now be able to be separated by pulling apart. Inspect the covers to ensure there is no damage, if the cover is cut or the reinforcement is exposed, the hoses must not be used.

STEPS FOUR, FIVE, SIX

Follow Steps Two, Three and Four of page 326 for each end of the hose.

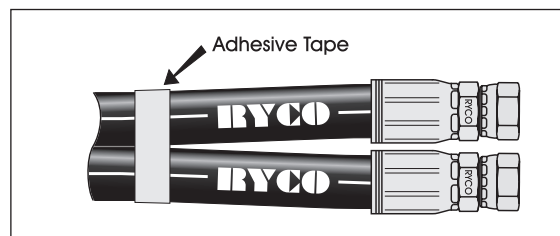

STEP SEVEN

After crimping the couplings, the hoses can be tied together at the separation area with tape or a cable tie to prevent the hoses becoming further separated accidentally.

Couplings

Adaptors

Accessories

Filters

Technical